

Basic series
4 mm embeddable
increased operating distance

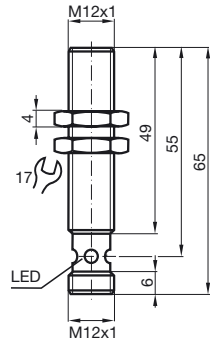

General specifications	
Switching element function	PNP Make function
Rated operating distance s_n	4 mm
Installation	embeddable
Assured operating distance s_a	0 ... 3,24 mm
Reduction factor r_{Al}	0,45
Reduction factor r_{Cu}	0,35
Reduction factor r_{V2A}	0,7
Nominal ratings	
Operating voltage U_B	10 ... 30 V
Switching frequency f	0 ... 1000 Hz
Hysteresis H	typ. 5 %
Reverse polarity protection	Protected against reverse polarity
Short-circuit protection	pulsing
Voltage drop U_d	≤ 3 V
Design data	
Operating current I_L	0 ... 150 mA
Off-state current I_r	0 ... 0,5 mA typ. 0,1 μ A at 25 °C
No-load supply current I_0	≤ 15 mA
Indication of the switching state	Multihole-LED, yellow
Standard conformity	
Standards	EN 60947-5-2
Ambient conditions	
Ambient temperature	-25 ... 70 °C (248 ... 343 K)
Mechanical specifications	
Connection type	V1-connector
Cable version	PBT
Housing material	brass, nickel-plated
Sensing face	PBT
Protection degree	IP67

Connection type:

